



Features:

- 2 Channel RCA Audio over Fiber Extend to 20 Km SMF / 2 Km MMF, Supports 24-Bit Digitally Encoded Analog Audio
- **Line Level** Unbalanced Audio Operation.
- No EMI, RFI, Cross Talk or Video Distortion and no ground loops; No Loss in Signal Quality
- Support Point-to-Point or Daisy-Chain (Cascaded Audio) connection
- LED Indicators for Instant System Monitoring
- Plug and Play (no software driver), Standalone or Rack Mount in FVC14 Chassis

Description:

BY-RCA-323-LC support 2 channels Audio (RCA) over one multi-mode / single-mode optical fiber. the set includes optical transmitter and receiver.

Applications: Rental, Staging, Theater, Stadiums, Theme Parks, Broadcast/Studio, CCTV audio and Professional AV etc

Specs:

Audio Channels: 2 Ch

Input/output Impedance: 600ohm(unbalanced)

Max input/output voltage: 3.0Vp-p

Frequency Response: 10 Hz~29kHz @±3dB

SNR: > 70dB

Connector: RCA

Electrical & Mechanical:

Input Power Requirements: DC 5V@2A

Power Adapter: AC 900V~240V

Power Consumption: < 3W

Stand-Alone Dimensions: 104 mm × 104 mm × 28 mm

Shipping Weight: (include Transmitter & Receiver) 0.8kg

Environmental:

Operating Temperature: -20°C ~ +75°C

Storage Temperature: -40°C ~ +85°C

Relative Humidity: 0% ~ 95% (non-condensing)

MTBF: >100,000 hours

Optical:

Wavelength: 1310nm

Supported Optical Fiber: Universal Single-mode Fiber / Multi-mode Fiber

Optical Connector: 1 x LC standard, 1 x ST, 1 x FC, 1 x SC optional

Distance: 20 Km (SMF), 2 Km (MMF)

BY-RCA-323-LC 2 Ch RCA Audio over Multimode or Single-mode Fiber Extender

V2.0 2016

Package:

1. 1 x transmitter 2. 1 x receiver 3. 2 x Power Supply Adapter DC 5~12V with US plug 4. 1 x Manual.

Measurement:

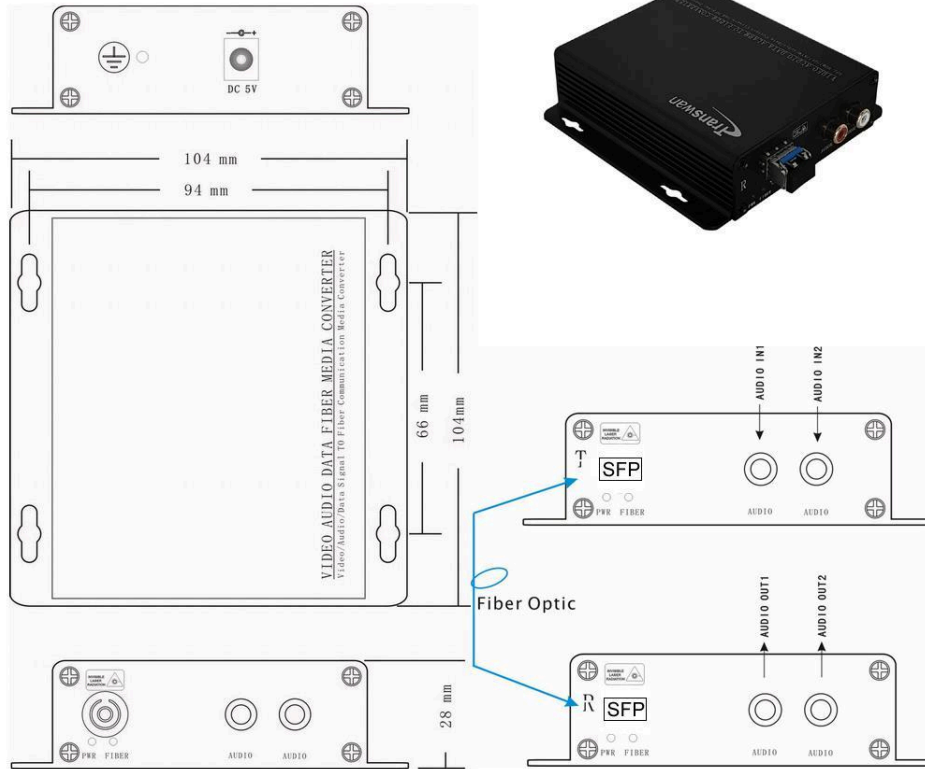

* Dimension

* Connection (Transmitter & Receiver's Panel)

